





-  STRUTTURE ANTICHE.
-  VINCOLO DIRETTO
-  VINCOLO INDIRETTO
-  AREA CIA' VINCOLATA



foglio 196

Foglio 198

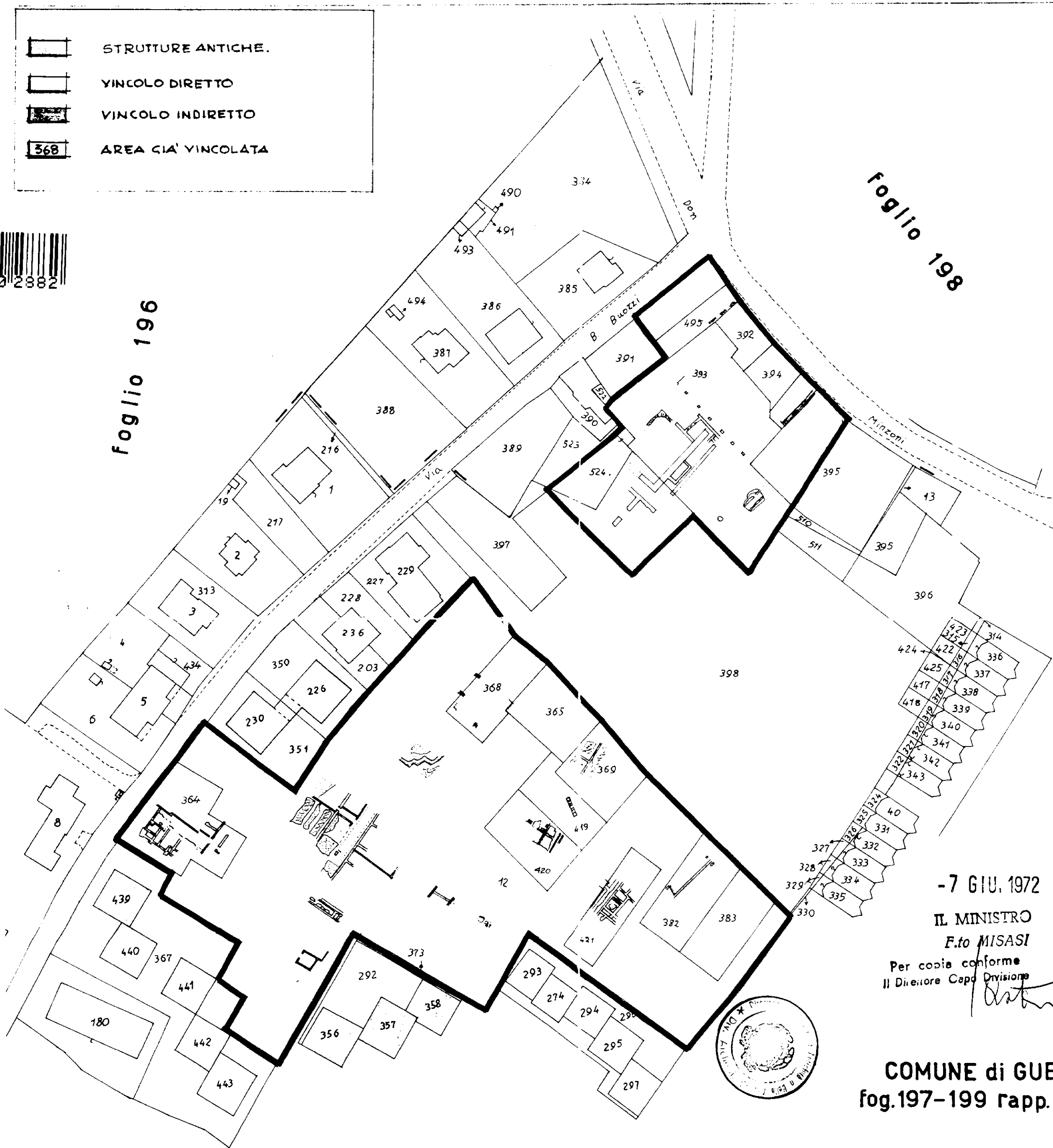

-7 GIU. 1972
 IL MINISTRO
 F.to MISASI
 Per copia conforme
 Il Direttore Capo Divisione



COMUNE di GUBBIO
 fog.197-199 rapp. 1:1000